

Memo

**Department of Corporate Services
Legal and Democratic Services**

To: For Circulation See Below

Property Commercial & Development
Law Team
Room 301, 3rd Floor
City Hall
Bradford
West Yorkshire
BD1 1HY
DX11758 BRADFORD -1

Ref: 17/00009/1

Date: 2nd November 2017

From: Linda Dewhirst
Legal Officer
Property Commercial & Development
Law Team

Tel: (01274) 434221
Fax: (01274) 432116
My Ref: CORP/PCD/LD/73953
Email: linda.dewhirst@bradford.gov.uk

**TOWN AND COUNTRY PLANNING ACT 1990 - SECTION 198
LAND TO THE REAR OF 19 & 21 ASHFIELD AVENUE, BRADFORD - TREE PRESERVATION
ORDER 2017**

The above Tree Preservation Order was confirmed without modifications on 2nd November 2017.
Please find attached a copy for your records.

Linda Dewhirst
Legal Officer

Enc

Arboricultural Technician
Development Services Tree Section
Department of Regeneration
4th Floor, Britannia House

Land Charges Manager
Local Land Charges
Britannia House

For TPO's in Shipley Area (including Bingley,
Wilsden, Harden, Cullingworth, Baildon)
Shipley Library
2 Wellcroft
Shipley
BD18 3QH

TOWN AND COUNTRY PLANNING ACT 1990

THE LAND TO THE REAR OF 19 & 21 ASHFIELD AVENUE, BRADFORD

TREE PRESERVATION ORDER 2017

The City of Bradford Metropolitan District Council in exercise of the powers conferred on them by Section 198 of the Town and Country Planning Act 1990 make the following Order:-

Citation

1. This Order may be cited as land to the rear of 19 & 21 Ashfield Avenue, Bradford.

Interpretation

2. (1) In this Order "the authority" means City of Bradford Metropolitan District Council.
- (2) In this Order any reference to a numbered section is a reference to the section so numbered in the Town and Country Planning Act 1990 and any reference to a numbered regulation is a reference to the regulation so numbered in the Town and Country Planning Act (Tree Preservation) (England) Regulations 2012.

Effect

3. (1) Subject to article 4, this Order takes effect provisionally on the date on which it is made.
- (2) Without prejudice to subsection (7) of section 198 (power to make tree preservation orders) or subsection (1) of section 200 (tree preservation orders: Forestry Commissioners) and, subject to the exception in regulation 14, no person shall:-
 - (a) cut down, top, lop, uproot, wilfully damage, or wilfully destroy; or
 - (b) cause or permit the cutting down, topping, lopping, wilful damage or wilful destruction of,

any tree specified in the Schedule to this Order except with the written consent of the authority in accordance with regulations 16 and 17, or of the Secretary of State in accordance with regulation

TREE PRESERVATION ORDER 17/00009/1
LAND TO THE REAR OF 19 & 21 ASHFIELD AVENUE, BRADFORD

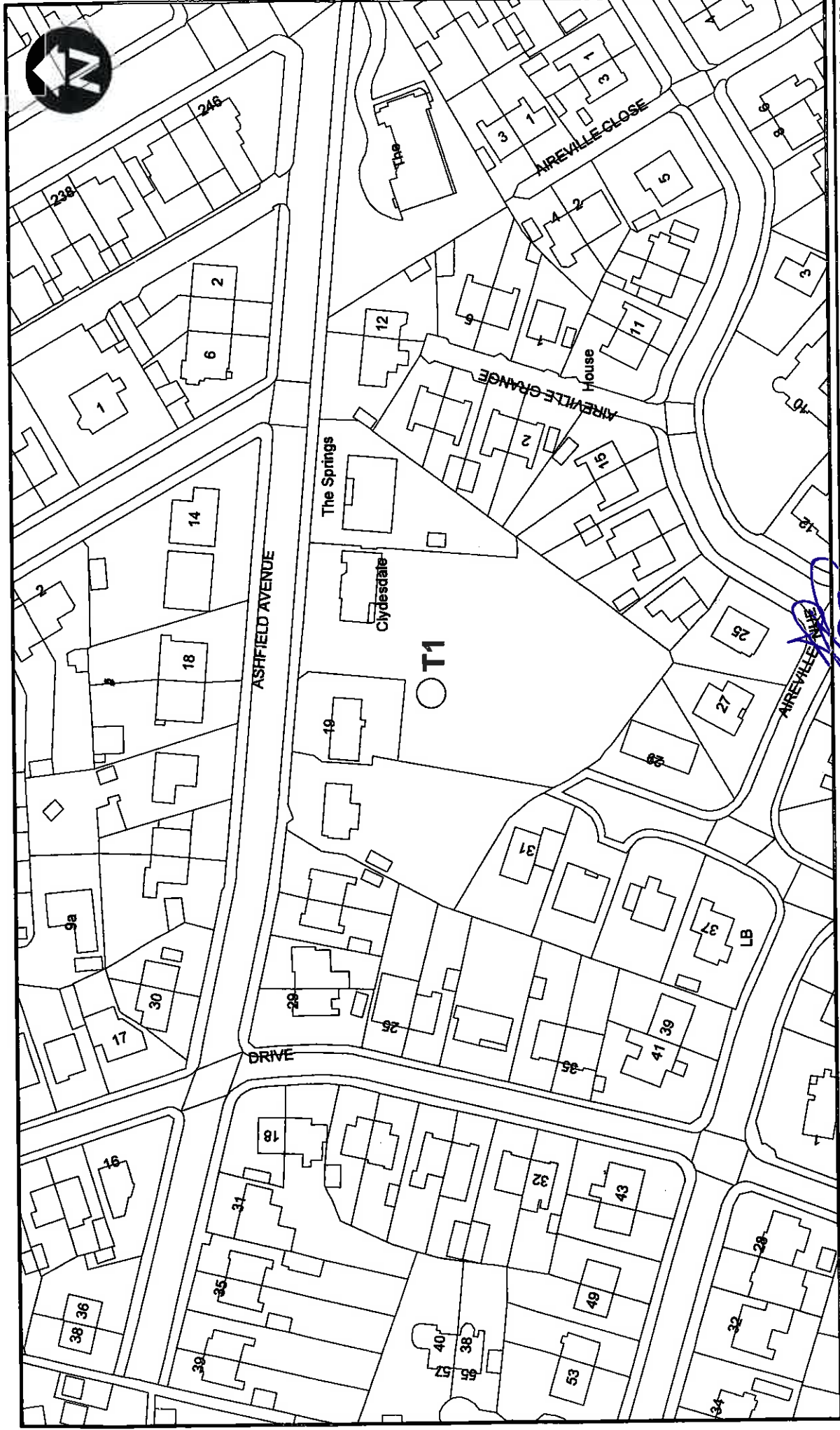

Scale 1: 1250
OS Ref: SE1436
Reproduced from the Ordnance Survey map with
the sanction of HM Stationery Office
Copyright reserved
LA076120

TREE PRESERVATION ORDER
17/00009/1
LAND TO THE REAR OF 19 AND 21 ASHFIELD AVENUE
BRADFORD

DEPARTMENT OF PLACE
Britannia House
Aireville
BD1 1HX

23 and, where such consent is given subject to conditions, in accordance with those conditions.

Application to trees to be planted pursuant to a condition

- 4. In relation to any tree identified in the first column of the Schedule by the letter "C", being a tree to be planted pursuant to a condition imposed under paragraph (a) of section 197 (planning permission to include appropriate provision for preservation and planting of trees), this Order take effect as from the time when the tree is planted.

Dated this 19th day of September 2017.

98346

EXECUTED AS A DEED by affixing
THE COMMON SEAL of **THE CITY**
OF BRADFORD METROPOLITAN
DISTRICT COUNCIL in the presence of:-

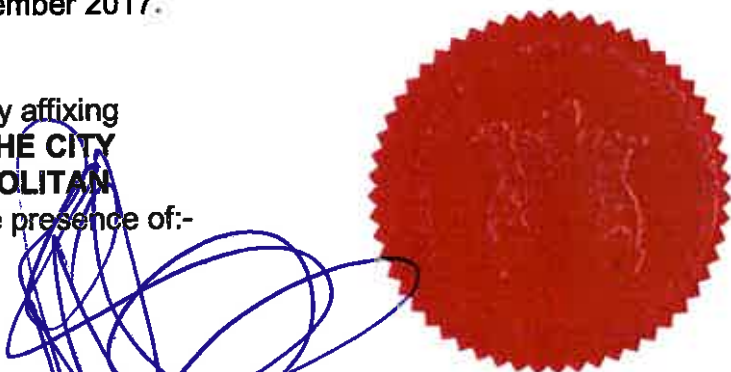

Authorised by the City Solicitor

CONFIRMATION OF ORDER

This Order was confirmed by the City of Bradford Metropolitan District Council without modification on the 2nd day of ~~NOVEMBER~~ 2017

OR

The Order was confirmed by the City of Bradford Metropolitan District Council subject to the modification indicated by ~~the~~ on the ~~day of~~

EXECUTED AS A DEED by affixing
THE COMMON SEAL of **THE CITY**
OF BRADFORD METROPOLITAN
DISTRICT COUNCIL in the presence of:-

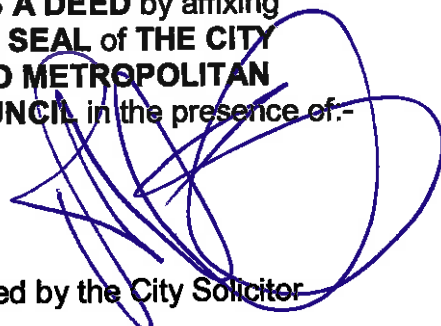

Authorised by the City Solicitor

98453

REVOCAION OF ORDER

This Order was revoked by the City of Bradford Metropolitan District Council on the day of

EXECUTED AS A DEED by affixing
**THE COMMON SEAL of THE CITY
OF BRADFORD METROPOLITAN
DISTRICT COUNCIL** in the presence of:-

Authorised by the City Solicitor

SCHEDULE**Specification of Trees****Trees specified individually**

(encircled in black on the map)

Reference on map	Description	Situation
T1	Sycamore	SE 414655 436155

Trees specified by reference to an area

(within a dotted black line on the map)

Reference on map	Description	Situation
None		

Groups of trees

(within a broken black line on the map)

Reference on map	Description	Situation
None		

Woodlands

(within a continuous black line on the map)

Reference on map	Description	Situation
None		